



TILT WATCH DETECTOR AND MARBLE TOPS HANDLING

All the marble tops of our dining and coffee tables with a diameter of more than 80 cm are packed and shipped separately in wooden cracks equipped with Tilt Watch Detector, in order to check that marbles are carried and handled correctly from our warehouse until delivery to the end customer.

All the cracks must be carefully kept in vertical position because marble, if laid horizontally, is put under tension and risks of breaking, especially in the weaker spots.

Therefore it is responsibility of customers, upon receipt of the goods, to check that the Tilt Watch Detector is in the correct position (see picture) and, if not, to sign the CMR with reserve. Only in this way the carrier's insurance will be held liable for the damage. Without reserve on the CMR, the costs to repair the damage will be charged to the customer.

However, it has to be clear that a Tilt Watch Detector in a non-correct position does not necessarily mean that marble is broken.

It is important to stress that marble tops must be kept in vertical position also during unpacking, until final assembling (see sheets).

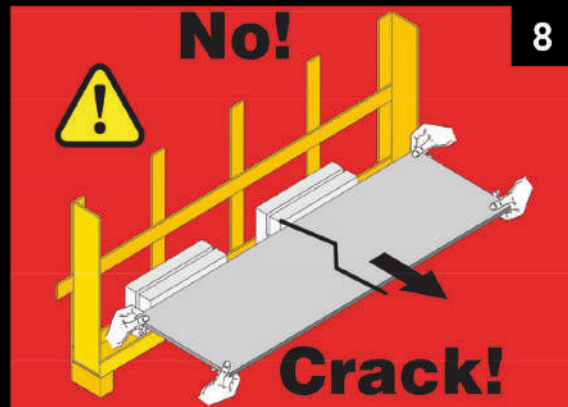
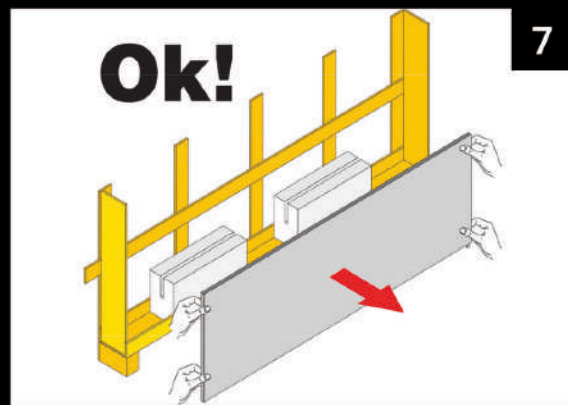
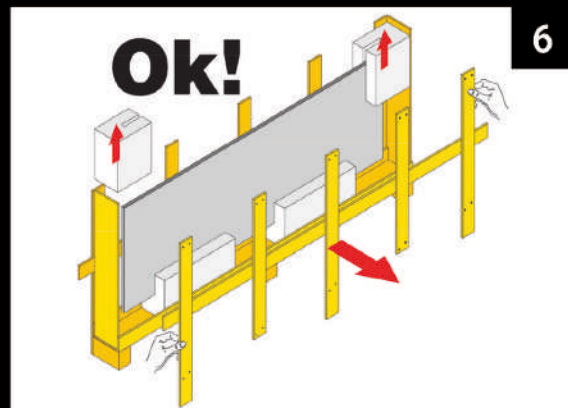
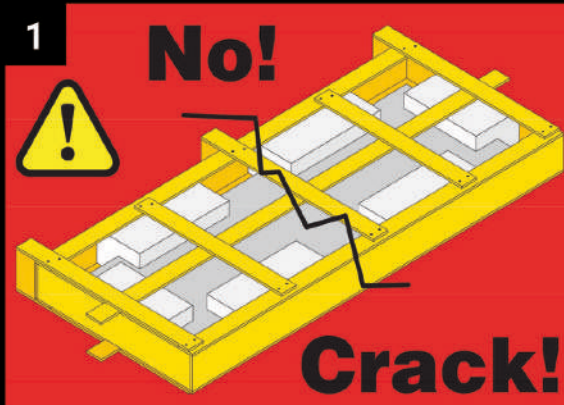

MOVIMENTAZIONE PIANI DI LAVORO WORKTOPS HANDLING



Ok!

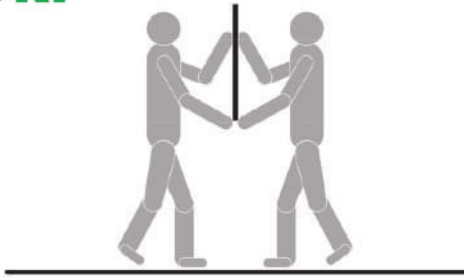

No!

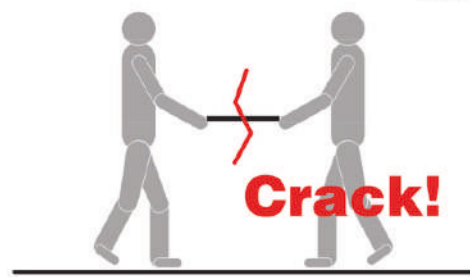

Ok!



No!



Ok!

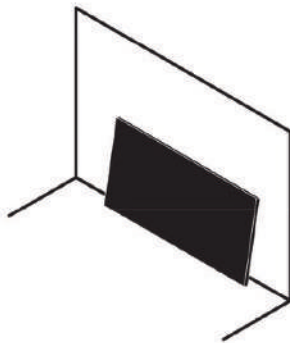

No!

Crack!

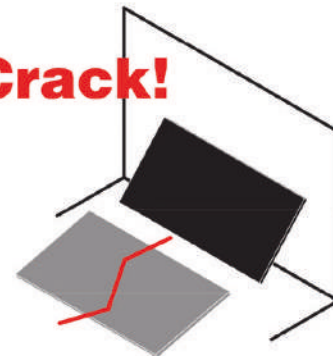

MOVIMENTAZIONE PIANI DI LAVORO WORKTOPS HANDLING

